

TRUSS CIRCLE / QUADRO 290 HD / 11000MM / 12pcs

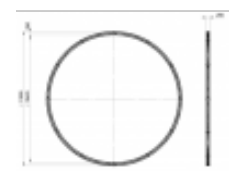

TECHNICAL DETAILS

Element	Circle
Parts	12
Color	Black
Material	EN AW-6082 T6
Material	42CrMo4 (Conical pin)
Material	2017A-T4 PA6 (Connecting pin)
Diameter (mm)	11000
Inner diameter (mm)	10420
Main tube diameter (mm×mm)	50x2
Braces (mm×mm)	20x2
Width (mm)	290
Height (mm)	290
Net weight (kg)	237
Set contains	12 x Curved truss Q290 (R5.5m / 30°)
Set contains	96 x Conical pin SZ02.03
Set contains	48 x Connecting pin SZ02.01
Set contains	96 x Split pin

PRODUCT DESCRIPTION

The ALUSTAGE truss system, which includes QUADRO-type trusses, makes it possible to create a circular structure with an outer diameter of 11000 mm and an inner diameter of 10420 mm.

The truss elements of the 290A model were made of 50x2 mm tubes and 20x2 mm laths. The structure was equipped with a connection socket of SZ02.10 type.

The wheel consists of 12 parts in the form of arched beams R5.5m / 30°, which makes it ideal for the construction of stages, stage structures and exhibition stands during trade fairs.

Get professional stage technology solutions at SQM Rental House!

Product link:

<https://rentalhouse.sqm.eu/gb/truss-constructions/2268-truss-circle-quadro-290-hd-11000mm-12pcs.html>